

Dell™ Dimension™ Systems

SETUP GUIDE

www.dell.com
support.dell.com



Notes, Notices, and Cautions

Throughout this guide, blocks of text may be accompanied by an icon and printed in bold type or in italic type. These blocks are notes, notices, and cautions, and they are used as follows:



NOTE: A NOTE indicates important information that helps you make better use of your computer system.

NOTICE: A NOTICE indicates either potential damage to hardware or loss of data and tells you how to avoid the problem.



CAUTION: A CAUTION indicates a potentially hazardous situation which, if not avoided, may result in minor or moderate injury.

**Information in this document is subject to change without notice.
© 1999–2000 Dell Computer Corporation. All rights reserved.**

Reproduction in any manner whatsoever without the written permission of Dell Computer Corporation is strictly forbidden.

Trademarks used in this text: *Dell*, the *DELL E COM* logo, *DellNet*, and *Dimension* are trademarks of Dell Computer Corporation; *Microsoft*, *Windows*, and *Windows NT* are registered trademarks of Microsoft Corporation.

Other trademarks and trade names may be used in this document to refer to either the entities claiming the marks and names or their products. Dell Computer Corporation disclaims any proprietary interest in trademarks and trade names other than its own.

August 2000 P/N 9558P Rev. A06



Dell™ Dimension™ Systems Setup Guide

Before using this guide, connect your computer according to the steps on the *Getting Started* sheet. Failure to properly connect your computer may result in computer malfunctions or damage.

Operating System Setup

Your Dell computer has been shipped with one of the following operating systems already installed:

- Microsoft® Windows® Millennium Edition (Me)
- Microsoft Windows 2000 Professional
- Microsoft Windows NT®
- Microsoft Windows 98 Second Edition

Perform the steps in one of the following sections that correspond to your operating system so that the software functions properly on your Dell computer.

NOTICE: To prevent possible conflicts with Windows Me, Windows 2000 Professional, or Windows 98 Second Edition, do not connect devices such as printers or install items such as expansion cards before you complete the operating system setup.

NOTICE: If you experience problems and the computer stops responding, do not use <Ctrl><Alt> to reboot your computer. Instead, press and hold the power button for approximately 4 seconds to shut down the computer. Then press the power button again to turn on the computer. When prompted, select Safe Recovery Mode to continue the setup.

Microsoft Windows Me

Initial setup of the Windows Me operating system takes approximately 5 minutes to complete. Additional setup time may be required, depending on your system's internal and external devices.

To complete the initial setup of Windows Me, perform the following steps:

1. Turn on your computer.
The **Welcome to Microsoft Windows** screen appears.
2. Click **Next**.
The **Select Your System Settings** window appears. Click your region, preferred language, and keyboard.
3. Click **Next**.
The **Select Your Time Zone** window appears.
4. Click your time zone and click **Next**.
The **End User License Agreement** window appears. It is important that you read and understand both license agreements. You must accept the agreements to proceed with the setup of your system.
5. Click **Yes. I accept this agreement** both places it appears in the window and click **Next**. If your computer has an internal modem, go to step 6. Otherwise, go to step 7.
6. When the **Register with Microsoft** window appears, if you want to register online, click **Yes, I want to register online**, click **Next**, follow the screen prompts, and fill in the appropriate information. If you do not want to register online, click **No, I do not want to register at this time**, click **Next**, and go to step 6.
7. When the **Thank You!** window appears, click **Finish** to begin working with Windows Me.

Microsoft Windows 2000 Professional

The initial setup of the Windows 2000 Professional operating system may take approximately 7 minutes. Additional setup time may be required, depending on your system's internal and external devices.

To set up Windows 2000 Professional for your system, perform the following steps:

1. Turn on your computer.
The **Software Licenses** screen appears.
2. Read the license agreements and press any key if you accept the agreements.
You must accept the agreements to proceed with the setup.
3. At the **Important Technical Support Information** screen, press any key to continue.
Your system restarts and the **Windows 2000 Professional Setup License Agreement** window appears.

4. Click **I accept this agreement**. Click **Next**.
5. In the **Personalize Your Software** window, type your name and the name of your organization. Then click **Next**.

You must type in a name, but the organization field is optional.

6. In the **Computer Name and Administrator Password** window, a suggested name for your computer appears in the name box that you can change or accept. You can leave the password field empty or add a password of up to 14 characters.

Leaving the password field empty is acceptable if you prefer not to use a password. Although the administrator password is optional, it is useful for protecting against unauthorized access to operating system settings. You may add or change a password later. More information on administrator and user logins is available from the Windows 2000 Help feature.



NOTE: Type the password carefully. It is case-sensitive, and if you lose or forget it, you must reinstall the operating system.

7. Click **Next**.
8. In the **Date and Time Settings** window, verify that the settings are correct for your time and time zone and click **Next**.

The **Networking Settings** window appears. You may choose whether to use typical or custom settings. See your network administrator if you need to add custom settings at this point.

9. Click **Next** to accept the default **typical** settings.

The **Workgroup or Computer Domain** window appears. You may add a workgroup name, but it is not required. Check with your network administrator if you need to add a computer domain.

10. Click **Next** to continue.

The **Performing Final Tasks** window appears. Then the following message appears:

You have successfully completed Windows 2000 Setup. If there is a CD in your drive, remove it. Then, to restart your computer, click Finish.

11. Click **Finish** to restart your computer.
12. When the **Welcome to the Network Identification Wizard** window appears, click **Next**.

The **Users of This Computer** window appears.

You can change settings as indicated on the screen or enter a user password for the name entered earlier in the setup. If you prefer to configure users later, you can accept the defaults on the screen and proceed.

13. Click **Next**.

More information on the Network Identification Wizard and administrator and user logins is available from the Windows 2000 Help feature.

14. When the **Completing the Network Identification Wizard** window appears, click **Finish**.

The **Getting Started with Windows 2000** window appears. You can exit from this windows and begin working on the desktop, or you can click any of the items in the window.

Microsoft Windows 98 Second Edition

Initial setup of Windows 98 Second Edition takes about 15 minutes. The setup process is customized according to which computer components you have. To complete setup, perform the following steps:

1. If you have a modem installed in your computer, connect a telephone line to it as shown on the *Getting Started* sheet that accompanied your computer.
2. Turn on your computer as shown on the *Getting Started* sheet.

The **Dell Software License** window appears.

3. Read the software license agreement that came with your computer, and then press any key to continue.

The **Important Technical Support Information** window appears and displays your Express Service Code.



NOTE: Dell's Express Service Code may not be available in all countries.

4. Press any key to continue.

The computer restarts automatically, and the Windows 98 screen is displayed for about 1 or 2 minutes. Although it may appear as if no activity is occurring, the operating system is actually loading program files.

5. When the **Getting Started** window appears, verify that the regional and keyboard setup and layout settings are correct for your location; then click **Next**. Otherwise, click the appropriate settings and then click **Next**.



*NOTE: If **Canadian Standard** keyboard type is selected, some keys on a standard English keyboard display characters on the screen that are different from the characters that are printed on the keys. For example, pressing the backslash (\) key displays the character à.*

6. When prompted, enter your name and click **Next**.

If your computer includes a modem, proceed to the next step. Otherwise, proceed to step 9.

7. A modem preparation window appears that allows you to connect to Microsoft and register your operating system. Click **Skip** and then click **Yes** and proceed to step 9, or enter the requested information and click **Next**.

A registration progress window appears while your modem connects to Microsoft.

8. To send the registration information to Microsoft, enter the requested information in the **Registration Confirmation** window and click **Next**. If you do not want the information sent, uncheck the **Please, send the information on this screen to Microsoft** box and click **Next**.

9. Read the license agreement, click **I accept the Agreement**, and then click **Next**.

You must accept the agreement to be able to access Windows 98 Second Edition.

10. If you ordered DellNet™ Internet service, click **Next** and proceed to the next step.

If a screen appears that prompts you to set up your Internet access or provides information about how to connect to the Internet, follow the instructions that appear on the screen or click **Skip** to bypass Internet setup and information.

If no prompt appears, proceed to the next step.

11. If an animated tutorial starts and introduces you to your computer and the Microsoft products installed on it, watch the tutorial and then click **Next**.

12. Click **Finish**.

13. If the **Date/Time Properties** window shows the correct time and date for your area, click **Close**. Otherwise, enter the correct time and date, click **Apply**, and then click **OK**.

Windows 98 Second Edition is now set up and the Windows desktop appears on the screen.

14. If the IntelliMouse **Productivity Tips** window is open on the Windows desktop, read the window's contents. Click the **Show Tips at Windows Startup** box to uncheck it, and then close the window by clicking the **X** in the upper-right corner.

Depending on the options that you purchased with your computer, you *may* have a **Complete Dell Setup** icon on the Windows desktop (see Figure 1).



Figure 1. Complete Dell Setup Icon (Not Present on Some Computers)

If you *do not* see the **Complete Dell Setup** icon on the desktop, no action is required.

If you *do* see the **Complete Dell Setup** icon on the desktop, double-click the icon. When the computer completes the setup, a dialog box instructs you to restart the computer. After you restart the computer, the **Complete Dell Setup** icon no longer appears.

Proceed to “Adding a Printer” for instructions on how to connect a printer and to “Finding Information” for descriptions of help and reference tools that are included with your Dell computer.

Microsoft Windows NT

If you are on a local area network (LAN), check with your network administrator *before* setting up Windows NT for information relevant to the setup process, such as the computer name, the administrator password, and required network protocols. Also attach the network cable (if applicable) and connect any devices you want to use with your computer as shown on the *Getting Started* sheet that accompanied your computer.

NOTICE: Do not interrupt the operating system’s setup process. Doing so may render your computer unusable.

Initial setup of Windows NT takes about 15 minutes. The setup process is customized according to which computer components you have. To configure Windows NT for your computer, perform the following steps:

1. Turn on your computer as shown on the *Getting Started* sheet that accompanied your computer.

The **Dell Software License Agreement** screen appears.

2. Read the license agreement and type *y* if you accept the agreement.

You must accept the agreement to proceed with the setup.

3. In the **Technical Support Information** window, type *x* to continue.

The computer restarts, and Windows NT prepares your computer for setup.

The computer restarts again, and the **Select Operating System** window appears. No action is required at this screen.

4. Click **I Agree** to accept the Microsoft software license agreement.

You must accept the Microsoft software license agreement to proceed with the Windows NT operating system setup.

5. At the **Windows NT Workstation Setup** screen, type your name (required) and organization (optional) and click **Next**.

6. In the **Registration** window, type the Product Key (use the <Tab> key to change fields), and then click **Next**.

The Product Key is the bar code number found on the Microsoft sticker, which is located either on the front cover of the *Getting Started/Microsoft Windows NT* document or on your computer.

7. In the **Password** window, type your chosen password in the **Password** field and again in the **Confirm Password** field, and then click **Next** twice.

The password can be up to 14 characters in length. You do not have to enter a password if you do not want to use one.



NOTES: The password controls access to your computer. If you have trouble remembering it, you should write the password down and store it in a safe place.

Type the password carefully. It is case-sensitive, and if you lose or forget it, you must reinstall the operating system.

8. If you do not have a network interface controller (NIC) installed in your computer, proceed to step 9.

If you do have a NIC installed, the **Windows NT Workstation Setup** window appears. Dell recommends that you click **Do not connect this computer to a network at this time**, and then click **Next** and finish the Windows NT setup procedure. After Windows NT setup is complete, use the **Network** icon in the **Control Panel** to configure the network.

9. Click **Restart Computer** in the **Windows NT Setup Complete** window to reboot the computer.

When the computer restarts, you are prompted to select an operating system.

10. Select **Windows NT WorkStation Version 4.00** and press <Enter>.

If **Windows NT WorkStation Version 4.00** is not already selected, use the up- or down-arrow key to highlight it.

11. Press <Ctl><Alt> simultaneously at the **Begin Logon** window.

12. Type your password and click **OK**.

The **Welcome to Windows NT** window appears. You can exit from this window and begin working on the desktop, or you can click either of the following items for additional information:

- **What's New** — Learn about new features of Windows NT 4.0.

- **Help** — Use the search facility to find information on a particular subject, title, word, or phrase.

Depending on the options that you purchased with your computer, you *may* have a **Complete Dell Setup** icon on the Windows desktop (see Figure 1).

If you *do not* see the **Complete Dell Setup** icon on the desktop, no action is required.

If you *do* see the **Complete Dell Setup** icon on the desktop, double-click the icon. When the computer completes the setup, a dialog box instructs you to restart the computer. After you restart the computer, the **Complete Dell Setup** icon no longer appears.

Creating a Windows NT Emergency Repair Diskette

The emergency repair diskette saves your original configuration and can be used to restore your computer to its initial setup state if files become corrupted. It should not be used as a backup tool.

To create the emergency repair diskette, perform the following steps:

1. Click the **Start** button, point to **Programs**, and click the **Dell Accessories** folder.
2. Click the **Create Repair Disk** icon.
3. In the **Repair Disk Utility** window, click **Create Repair Disk**.
4. Label a diskette "Emergency Repair Disk," insert it into the diskette drive, and click **OK**.

The diskette is formatted and the configuration files are copied to it.

5. When the **Repair Disk Utility** window reappears, click **Exit**.
6. Remove the diskette from your diskette drive, and store it in a safe place.

Adding a Printer

This section provides instructions on how to prepare and add a parallel printer or a Universal Serial Bus (USB) printer to the computer.

Preparing a Printer

See the documentation that came with the printer for any recommended preparation procedures. You may be instructed to perform the following tasks:

- Remove the manufacturer's shipping packaging
- Install the toner cartridge
- Align the toner cartridge
- Load printer paper

Connecting a Parallel Printer

NOTICE: Use only a standard IEEE parallel cable measuring 3 meters (10 feet) or less to connect the printer to the computer. Use of a non-standard cable may prevent the printer from operating properly.

To connect the printer to the computer, perform the following steps:

1. Turn off the computer and make sure that the printer is also turned off.
2. Attach the printer cable to the parallel connector on the computer and the printer.

Secure the printer cable connector to the computer connector by tightening the two screws (see Figure 2). Secure the printer cable connector to the printer connector by snapping the two clips into the two notches.

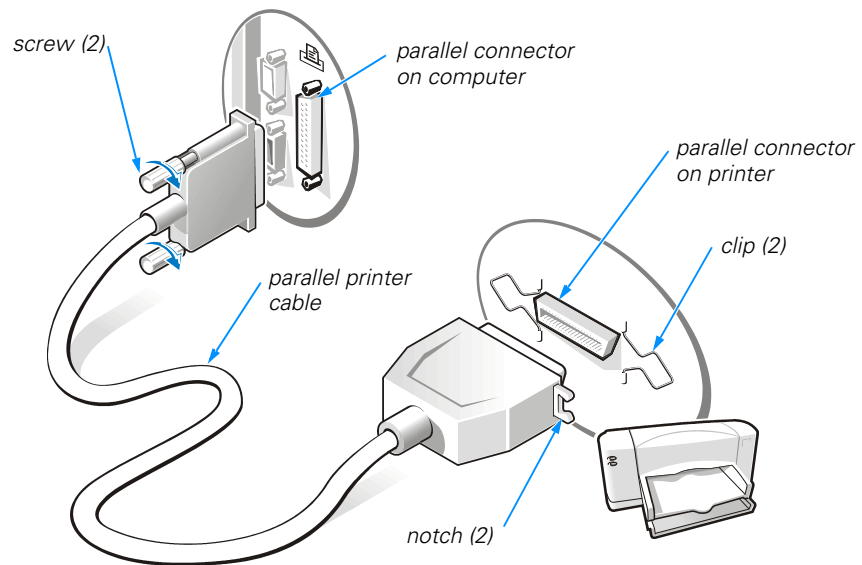

Figure 2. Parallel Printer Connections

3. Turn on the printer and then turn on the computer.

NOTE: If the **Add New Hardware Wizard** screen appears, click **Cancel**.

4. Proceed to "Installing Software for a Printer."



Connecting a USB Printer

NOTE: USB devices can be connected to the computer while it is on.

To connect the printer to the computer, perform the following steps.

NOTICE: Do not plug a USB printer into the port on the USB keyboard. The USB keyboard does not supply power to the USB port.



1. Attach the printer cable to the USB connector on the computer and the printer.
The USB connectors are keyed to fit only one way.
An example of a typical USB printer setup is shown in Figure 3.

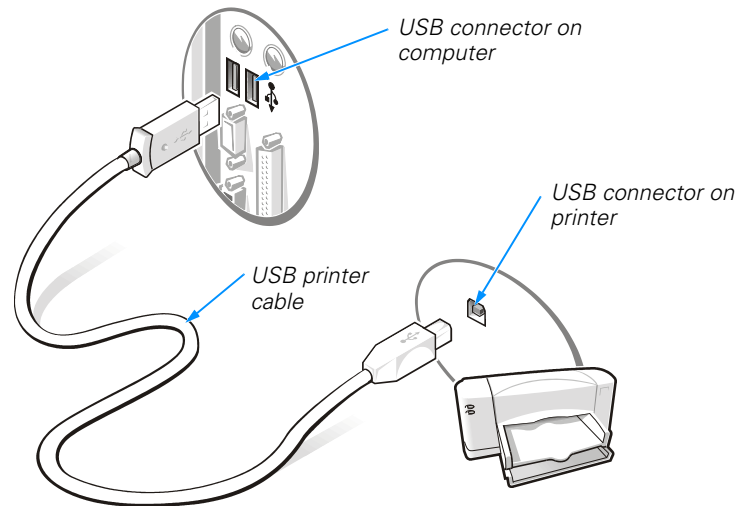

Figure 3. USB Printer Connections



*NOTE: If the **Add New Hardware Wizard** screen appears, click **Cancel**.*

2. Proceed to "Installing Software for a Printer."

Installing Software for a Printer



*NOTE: Dell installs the software for some new printers. To determine if your printer's software is already installed, click the **Start** button, point to **Settings**, and then click **Printers**. If your printer is listed in the **Printers** window, the printer is ready to use; no software installation is required.*

Most new printers provide installation CDs that run automatically when inserted in the CD-ROM or DVD-ROM drive. Install the software for these printers by inserting the CD and following the prompts on your screen using the instructions that came with the printer. It is not necessary to use the **Printer Wizard** to install these types of printers.

If your printer's installation CD does not automatically run, click the **Start** button, click **Run**, and type `x:\setup.exe`, where *x* is the letter of your CD-ROM or DVD-ROM drive (typically drive D). Then click **OK** and follow the prompts on your screen.



NOTE: If you are adding an older printer and the printer does not respond after you install the software, make sure that the computer's parallel port is set to operate in

bidirectional mode in the system setup program. Refer to Appendix B, "System Setup Program," in your computer's Reference and Troubleshooting Guide for instructions.

Finding Information

Dell provides a number of handy help and reference tools to help you make the most of your computing experience.

Tutorials (U.S. Only)



Easy-to-use, animated tutorials introduce you to your computer and the Microsoft products installed on it. For more information about these tutorials, double-click the **i-Learn My Dell PC** icon on your desktop.

Online Help

The online system *Help* allows you to search for information in multiple ways. You can quickly link to information on the following topics:

- Hardware and software features of your computer
- Options and upgrades
- The Windows desktop, where you can change your wallpaper and screen saver, create shortcuts, and position icons
- Software access, installation, and removal
- Basic file management, such as finding, copying, deleting, and renaming files
- Tips on using your computer hardware
- Answers to commonly asked questions about your computer
- Phone numbers for contacting Dell for help



To open the *Help*, click the **Start** button, point to **Programs—> Dell Documents**, and click **Dell Dimension Help**.



You may also double-click the **Dell Documents** icon on the Windows desktop, click **System Information**, click **System Documentation**, and then click **Dell Dimension Help**.

Reference and Troubleshooting Guide

Your *Reference and Troubleshooting Guide* provides information on adding upgrades such as memory, performing basic troubleshooting procedures, and reinstalling drivers. It also covers technical specifications, the system setup program, and computer codes and messages.

Other Documentation

Online documentation is included for your computer devices (such as a video or modem card) and for any Dell options you purchase separately from your computer. To access this supplemental documentation, double-click the **Dell Documents** icon on the Windows desktop, click **System Information**, and then click **System Documentation**.

If you have a modem and Internet service, other helpful information is available at <http://support.dell.com/> or by double-clicking the **Internet Explorer** icon on the desktop, clicking **Favorites**, and then clicking **Dell Computer Corporation Recommended Sites**.

Turning Off the Computer

NOTICE: To prevent data loss, it is important that you perform a shutdown procedure before you turn off your computer.

Perform the steps in one of the following sections that correspond to your operating system so that the computer turns off properly.

Shutting Down the Computer in Windows 98 and Windows NT

1. Save and exit any application programs and files you have open.
2. Click the **Start** button, and then click **Shut Down**.
3. In the **Shut Down Windows** window, click **Shut down** and then click **OK**.
The computer automatically turns off after the shutdown process finishes.
4. Turn off your monitor and any other devices connected to power.

Shutting Down the Computer in Windows 2000 and Windows Me

1. Save and exit any application programs and files you have open.
2. Click the **Start** button, and then click **Shut Down**.
3. Click the pull-down menu under **What do you want the computer to do?**.
4. Click **Shut down** and then click **OK**.
The computer automatically turns off after the shutdown process finishes.
5. Turn off your monitor and any other devices connected to power.